

REVISION HISTORY			
REV	DESCRIPTION	DATE	APPROVED
C	ADDED STACKING BRACKET	2012-04-29	AK

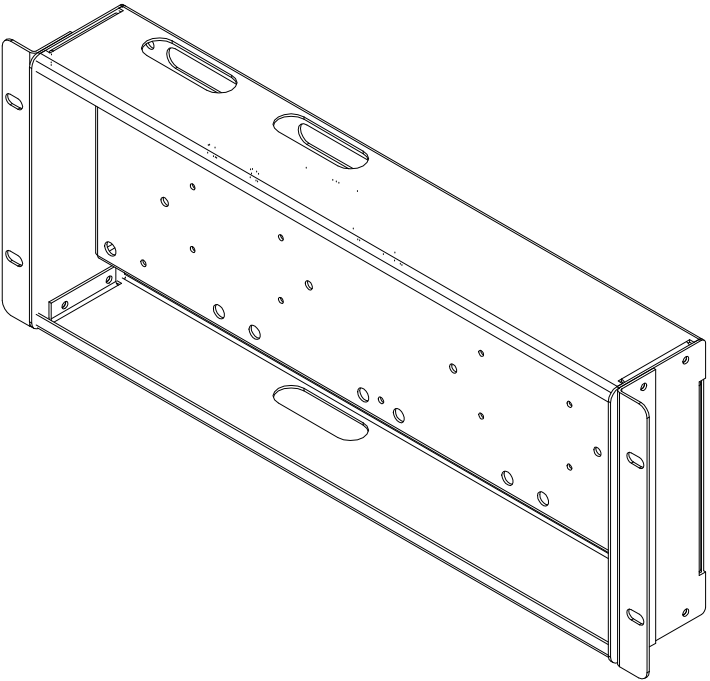

PARTS REQUIRED FOR 1 UNIT:

- | | |
|-----------------------------|------|
| - 001 BOTTOM COVER | - 1X |
| - 002 MODULE MOUNTING PLATE | - 1X |
| - 003 SIDE PANEL | - 2X |
| - 004 RACK EAR | - 2X |
| - 005 STACKING BRACKET | - 1X |

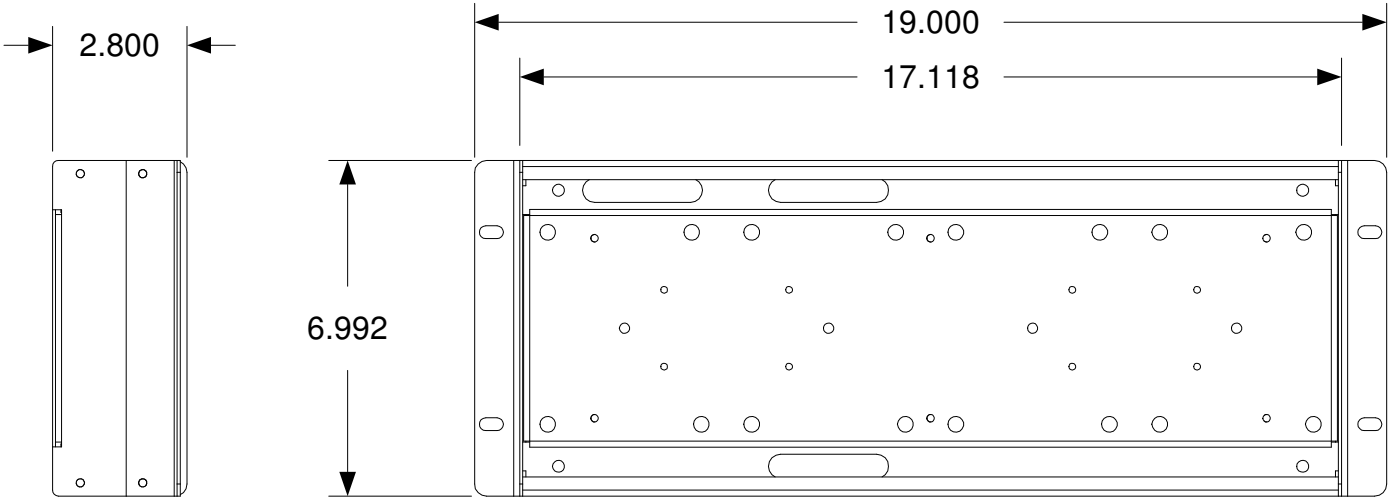
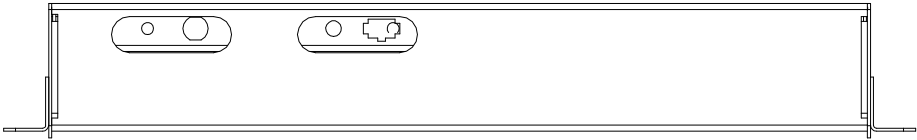
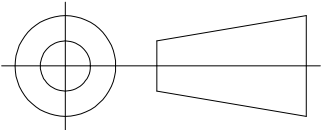

MATERIAL	VARIOUS	UNLESS SPECIFIED: ALL DIMENSIONS ARE INCHES TOLERANCES: ANGULAR: MACH: 0.5 BEND: 0.5 ONE DECIMAL: 0.050" TWO DECIMAL: 0.005" THREE DECIMAL: 0.005"	KILPATRICK AUDIO						
FINISH	VARIOUS		TITLE ANDREW 4-SPACE ENCLOSURE OVERALL VIEWS						
			SIZE B	CAGE CODE		DWG NO	ANDREW-4_SPACE- OVERALL		REV C
NEXT ASSY	USED ON		SCALE 1:4					SHEET	
APPLICATION									

REVISION HISTORY			
REV	DESCRIPTION	DATE	APPROVED
C	ADDED STACKING BRACKET	2012-04-29	AK

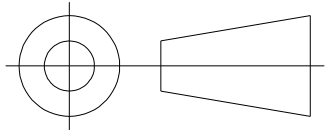
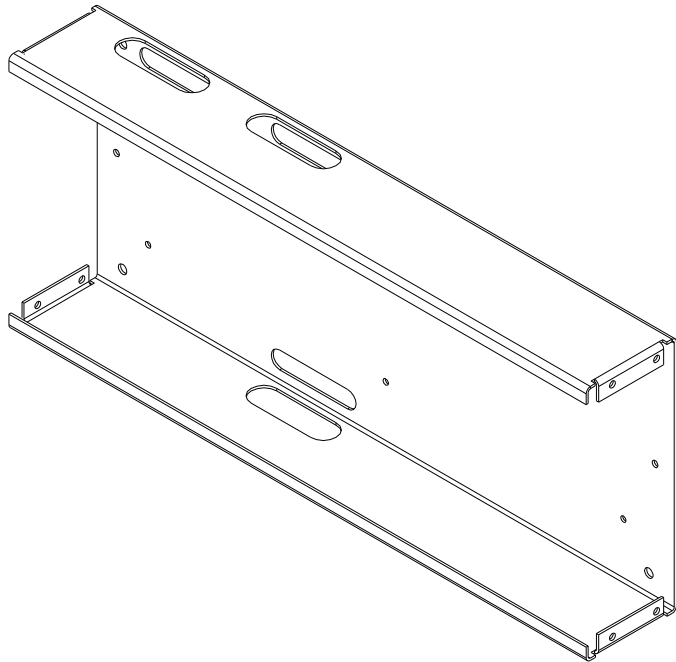
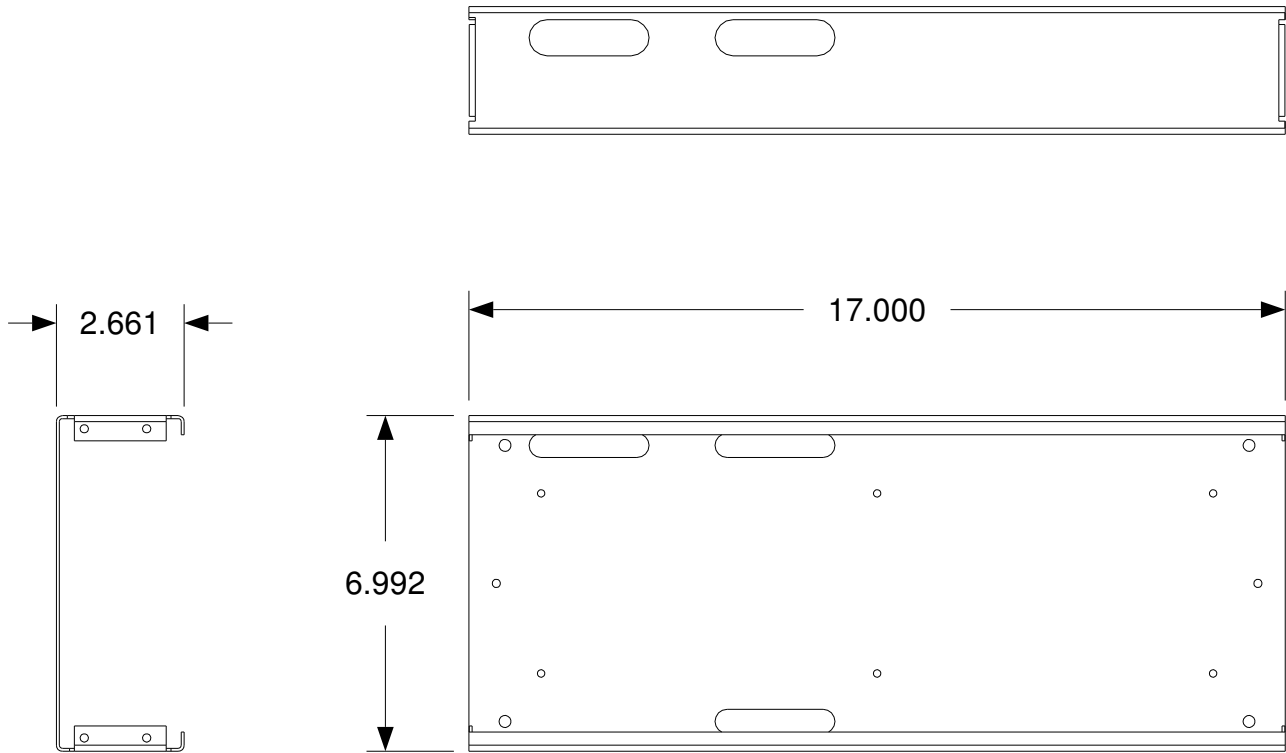

MATERIAL	14GA (0.063")	UNLESS SPECIFIED: ALL DIMENSIONS ARE INCHES TOLERANCES: ANGULAR: MACH: 0.5 BEND: 0.5 ONE DECIMAL: 0.050" TWO DECIMAL: 0.005" THREE DECIMAL: 0.005"	KILPATRICK AUDIO				
	5052 ALUMINUM		TITLE ANDREW 4-SPACE ENCLOSURE BOTTOM COVER				
FINISH	GRAPHITE						
	SANDTEX						
			SIZE B	CAGE CODE	DWG NO	ANDREW-4 SPACE-001	REV C
NEXT ASSY	USED ON	SCALE	1:4		SHEET		
APPLICATION							

REVISION HISTORY			
REV	DESCRIPTION	DATE	APPROVED
C	ADDED STACKING BRACKET	2012-04-29	AK

Hole Table				
Hole	X	Y	Da	Note
1	0.250	11.574	Ø0.172	
2	0.250	10.274	Ø0.172	
3	17.554	11.574	Ø0.172	
4	17.554	10.274	Ø0.172	
5	0.250	2.361	Ø0.172	
6	0.250	1.061	Ø0.172	
7	17.554	2.361	Ø0.172	
8	17.554	1.061	Ø0.172	
9	1.152	9.193	Ø0.250	
10	1.152	3.443	Ø0.250	
11	16.652	9.193	Ø0.250	
12	16.652	3.443	Ø0.250	
13	0.969	6.318	Ø0.172	
14	16.835	6.318	Ø0.172	
15	1.902	8.193	Ø0.156	
16	1.902	4.443	Ø0.156	
17	8.902	8.193	Ø0.156	
18	8.902	4.443	Ø0.156	
19	15.902	8.193	Ø0.156	
20	15.902	4.443	Ø0.156	

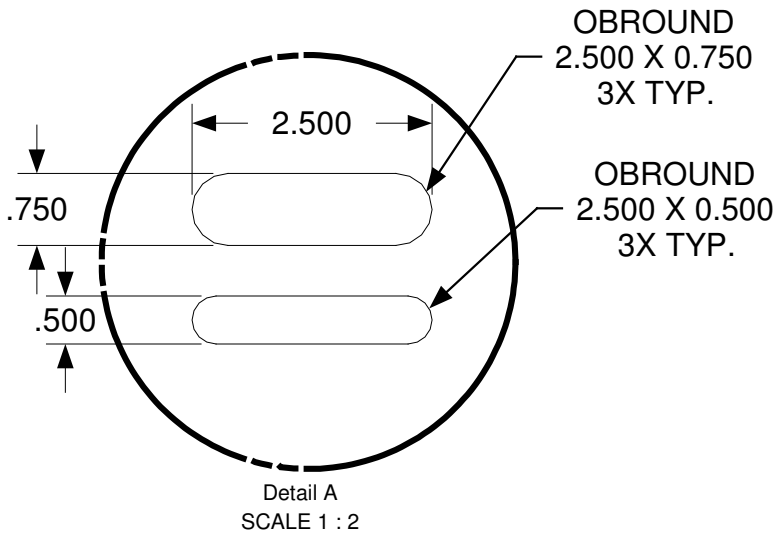
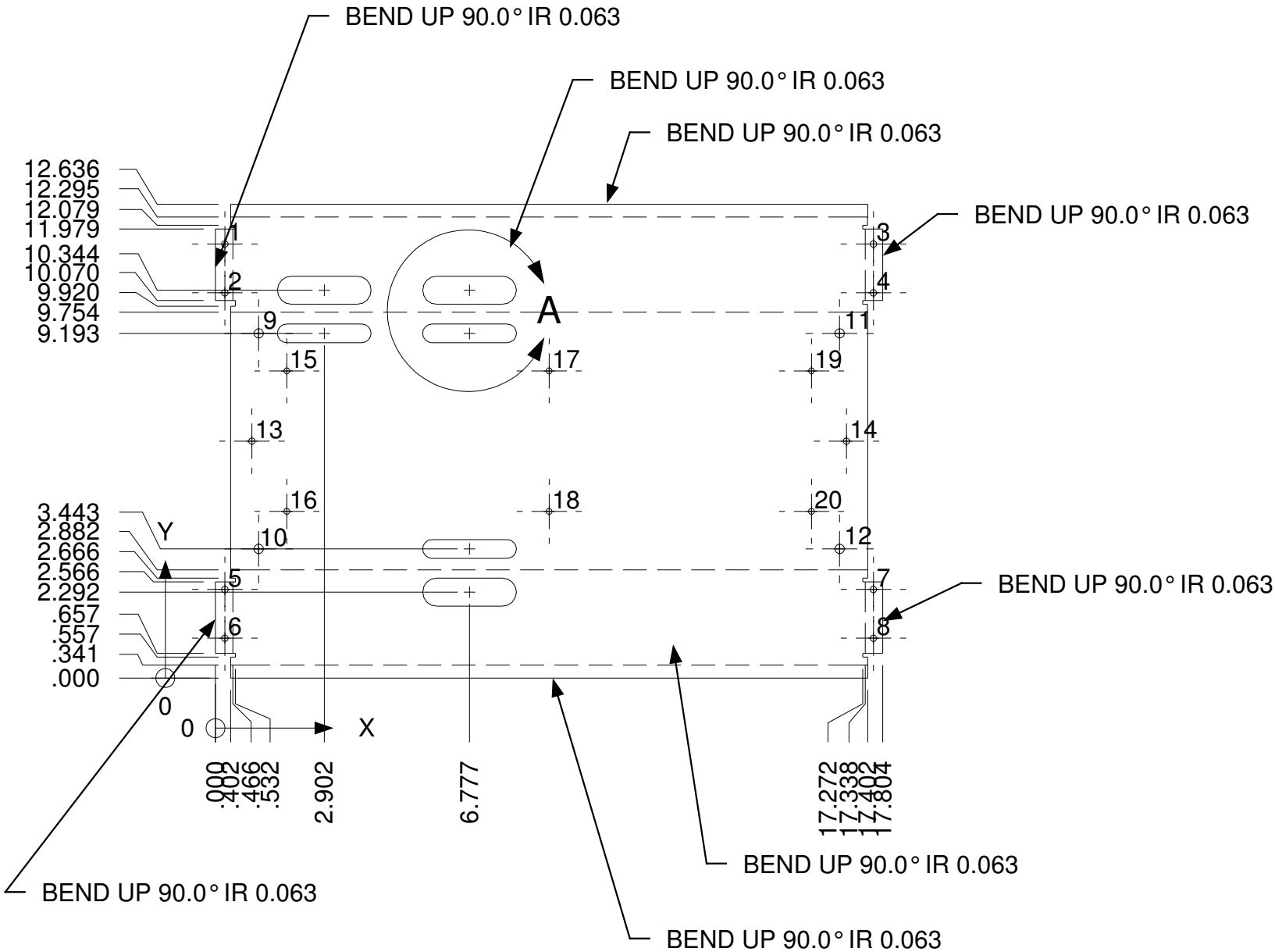

NOTE: HOLES ARE NOT SHOWN IN THE ORDINATE DIMENSIONS

MATERIAL		UNLESS SPECIFIED: ALL DIMENSIONS ARE INCHES		KILPATRICK AUDIO			
14GA (0.063") 5052 ALUMINUM		TOLERANCES: ANGULAR: MACH: 0.5 BEND: 0.5		TITLE ANDREW 4-SPACE ENCLOSURE BOTTOM COVER (UNFOLDED)			
FINISH GRAPHITE SANDTEX		ONE DECIMAL: 0.050" TWO DECIMAL: 0.005" THREE DECIMAL: 0.005"		SIZE B	CAGE CODE	DWG NO ANDREW-4 SPACE-001-UF	REV C
NEXT ASSY USED ON APPLICATION				SCALE 1:4	SHEET		

REVISION HISTORY			
REV	DESCRIPTION	DATE	APPROVED
C	ADDED STACKING BRACKET	2012-04-29	AK

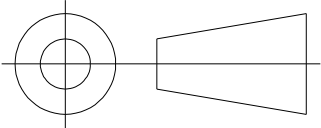
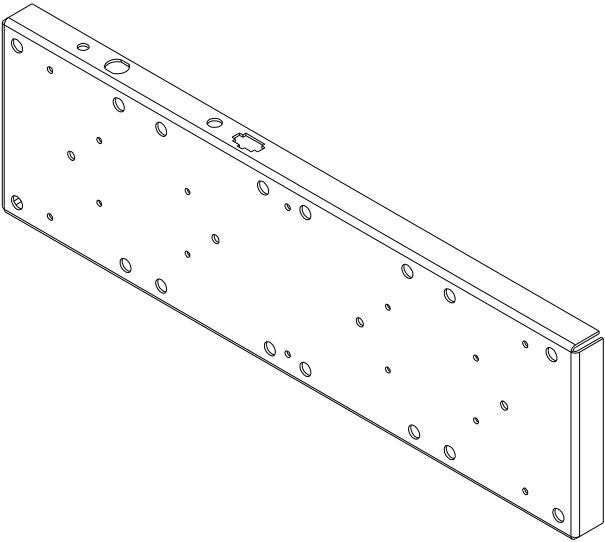
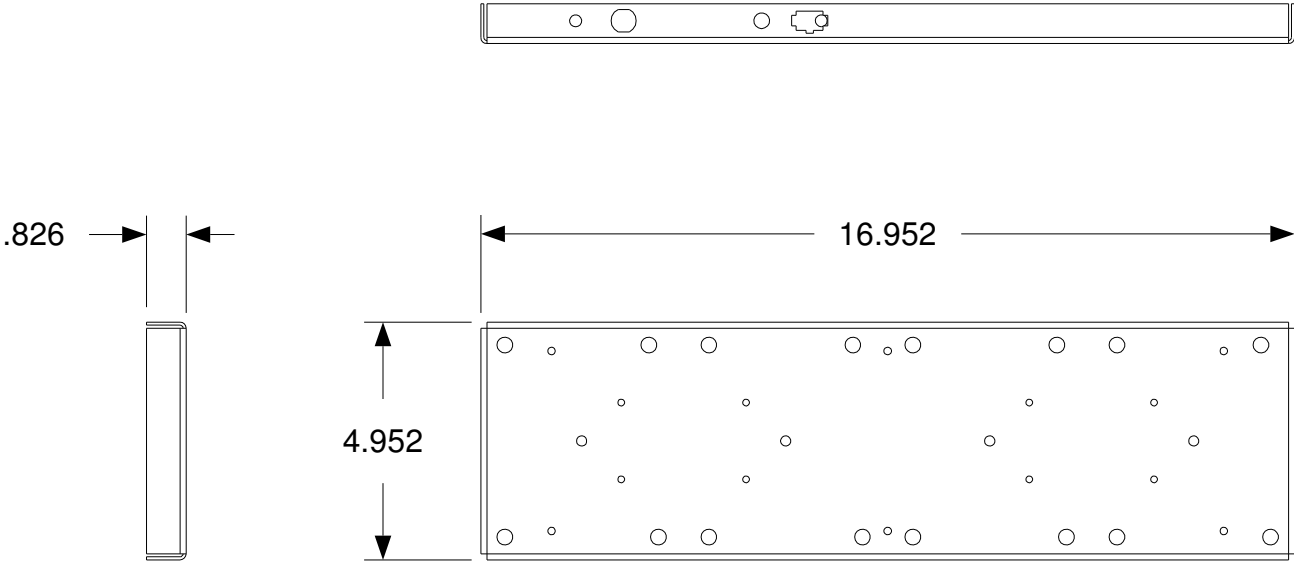

MATERIAL		14GA (0.063") 5052 ALUMINUM	UNLESS SPECIFIED: ALL DIMENSIONS ARE INCHES TOLERANCES: ANGULAR: MACH: 0.5 BEND: 0.5 ONE DECIMAL: 0.050" TWO DECIMAL: 0.005" THREE DECIMAL: 0.005"	KILPATRICK AUDIO			
FINISH		UNFINISHED					
NEXT ASSY		USED ON		TITLE ANDREW 4-SPACE ENCLOSURE MODULE MOUNTING PLATE			
APPLICATION				SIZE B	CAGE CODE	DWG NO	ANDREW-4 SPACE-002
				SCALE 1:4		SHEET	REV C

					REV SH	REV STATUS
--	--	--	--	--	-----------	---------------

REVISION HISTORY			
REV	DESCRIPTION	DATE	APPROVED
C	ADDED STACKING BRACKET	2012-04-29	AK

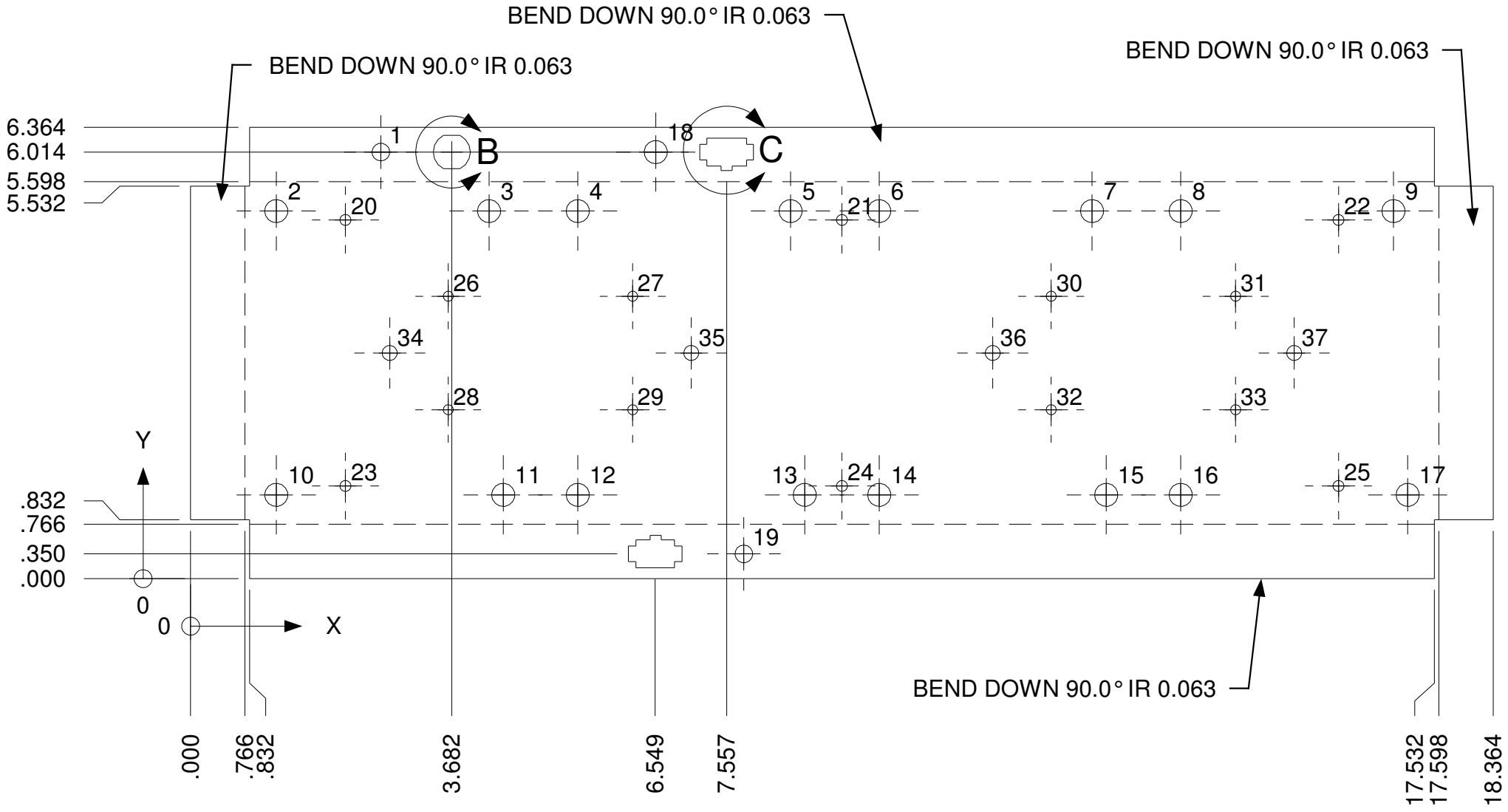

Hole Table				
Hole	X	Y	Dia	Note
1	2.682	6.014	Ø0.250	
2	1.207	5.182	Ø0.328	
3	4.207	5.182	Ø0.328	
4	5.457	5.182	Ø0.328	
5	8.457	5.182	Ø0.328	
6	9.707	5.182	Ø0.328	
7	12.707	5.182	Ø0.328	
8	13.957	5.182	Ø0.328	
9	16.957	5.182	Ø0.328	
10	1.207	1.182	Ø0.328	
11	4.407	1.182	Ø0.328	
12	5.457	1.182	Ø0.328	
13	8.657	1.182	Ø0.328	
14	9.707	1.182	Ø0.328	
15	12.907	1.182	Ø0.328	
16	13.957	1.182	Ø0.328	
17	17.157	1.182	Ø0.328	
18	6.557	6.014	Ø0.328	
19	7.799	0.349	Ø0.250	
20	2.182	5.057	Ø0.156	
21	9.182	5.057	Ø0.156	
22	16.182	5.057	Ø0.156	
23	2.182	1.307	Ø0.156	
24	9.182	1.307	Ø0.156	
25	16.182	1.307	Ø0.156	
26	3.632	3.982	Ø0.141	
27	6.232	3.982	Ø0.141	
28	3.632	2.382	Ø0.141	
29	6.232	2.382	Ø0.141	
30	12.132	3.982	Ø0.141	
31	14.732	3.982	Ø0.141	
32	12.132	2.382	Ø0.141	
33	14.732	2.382	Ø0.141	
34	2.807	3.182	Ø0.213	FEMESCA-3.5MB-8-ZI
35	7.057	3.182	Ø0.213	FEMESCA-3.5MB-8-ZI
36	11.307	3.182	Ø0.213	FEMESCA-3.5MB-8-ZI
37	15.557	3.182	Ø0.213	FEMESCA-3.5MB-8-ZI

NOTE: HOLES ARE NOT SHOWN IN THE
ORDINATE DIMENSIONS

PEM STANDOFFS PROTRUDE FROM
THIS SIDE

MATERIAL	14GA (0.063")	UNLESS SPECIFIED: ALL DIMENSIONS ARE INCHES TOLERANCES: ANGULAR: MACH: 0.5 BEND: 0.5 ONE DECIMAL: 0.050" TWO DECIMAL: 0.005" THREE DECIMAL: 0.005"	KILPATRICK AUDIO				
	5052 ALUMINUM		TITLE ANDREW 4-SPACE ENCLOSURE MODULE MOUNTING PLATE (UNFOLDED)				
FINISH	UNFINISHED						
				SIZE B	CAGE CODE	DWG NO	ANDREW-4 SPACE-002-UF
NEXT ASSY	USED ON		SCALE	1:2		SHEET	
APPLICATION							

REVISION HISTORY			
REV	DESCRIPTION	DATE	APPROVED
C	ADDED STACKING BRACKET	2012-04-29	AK

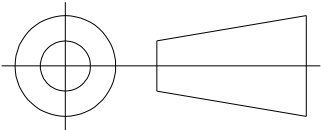
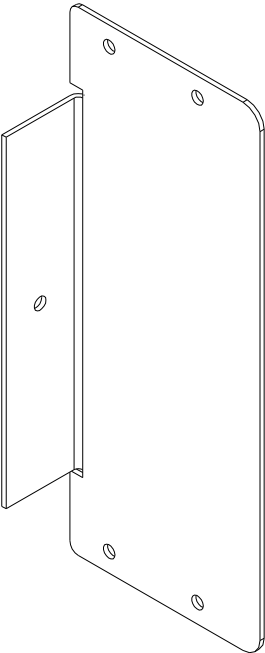
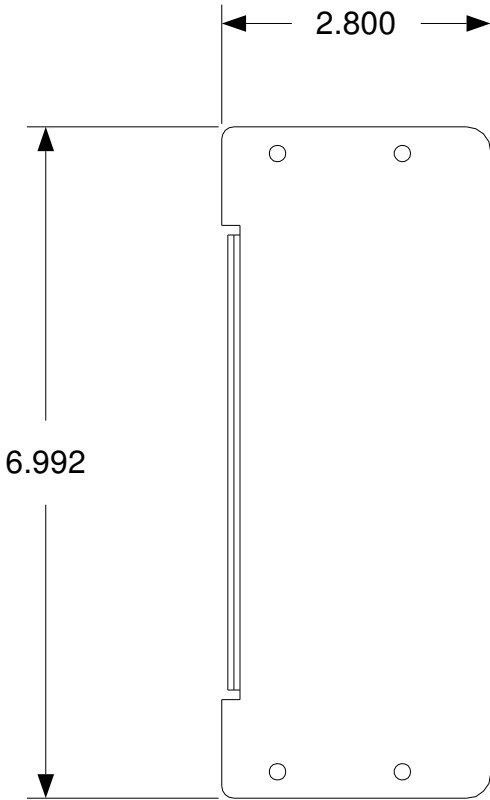
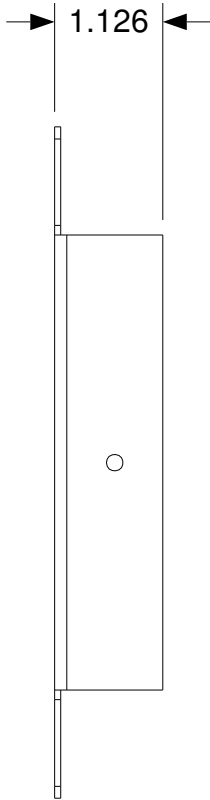

MATERIAL	14GA (0.063")	UNLESS SPECIFIED: ALL DIMENSIONS ARE INCHES TOLERANCES: ANGULAR: MACH: 0.5 BEND: 0.5 ONE DECIMAL: 0.050" TWO DECIMAL: 0.005" THREE DECIMAL: 0.005"	KILPATRICK AUDIO				
	5052 ALUMINUM		TITLE ANDREW 4-SPACE ENCLOSURE SIDE PANEL				
FINISH	GRAPHITE						
	SANDTEX						
			SIZE B	CAGE CODE	DWG NO	ANDREW-4 SPACE-003	REV C
NEXT ASSY	USED ON	SCALE	1:2			SHEET	
APPLICATION							

REVISION HISTORY			
REV	DESCRIPTION	DATE	APPROVED
C	ADDED STACKING BRACKET	2012-04-29	AK

Hole Table				
Hole	X	Y	Dia	Note
1	0.345	6.716	Ø0.172	
2	0.345	0.276	Ø0.172	

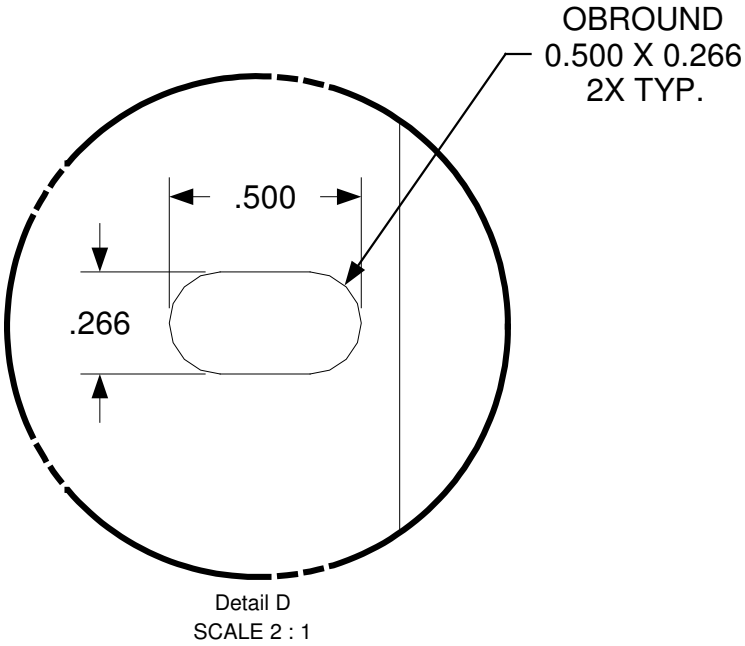
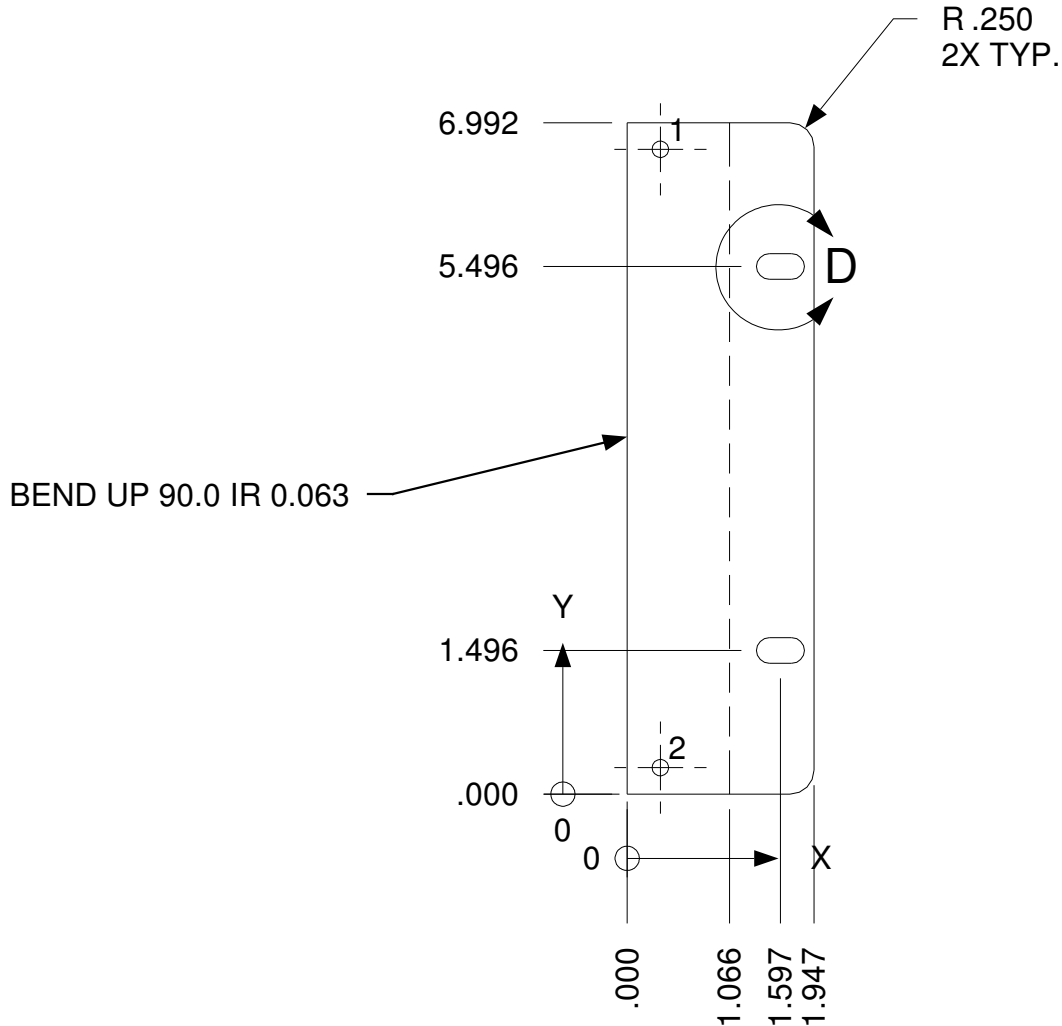

NOTE: HOLES ARE NOT SHOWN IN THE ORDINATE DIMENSIONS

PUNCH PART FROM OTHER SIDE

MATERIAL	14GA (0.063")	UNLESS SPECIFIED: ALL DIMENSIONS ARE INCHES TOLERANCES: ANGULAR: MACH: 0.5 BEND: 0.5 ONE DECIMAL: 0.050" TWO DECIMAL: 0.005" THREE DECIMAL: 0.005"	KILPATRICK AUDIO				
	5052 ALUMINUM		TITLE ANDREW 4-SPACE ENCLOSURE RACK EAR (UNFOLDED)				
FINISH	GRAPHITE						
	SANDTEX						
				SIZE B	CAGE CODE	DWG NO	ANDREW-4 SPACE-004-UF
NEXT ASSY	USED ON		SCALE	1:2		SHEET	
APPLICATION							

					REV	REV STATUS
					SH	

